

M/S MYRA































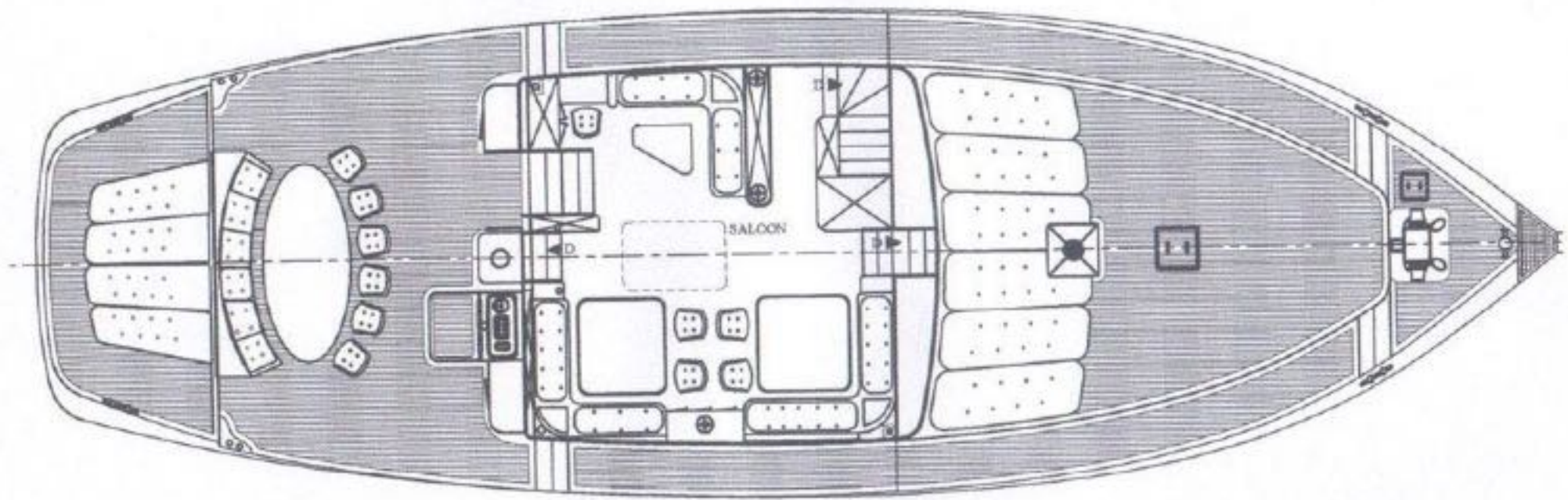

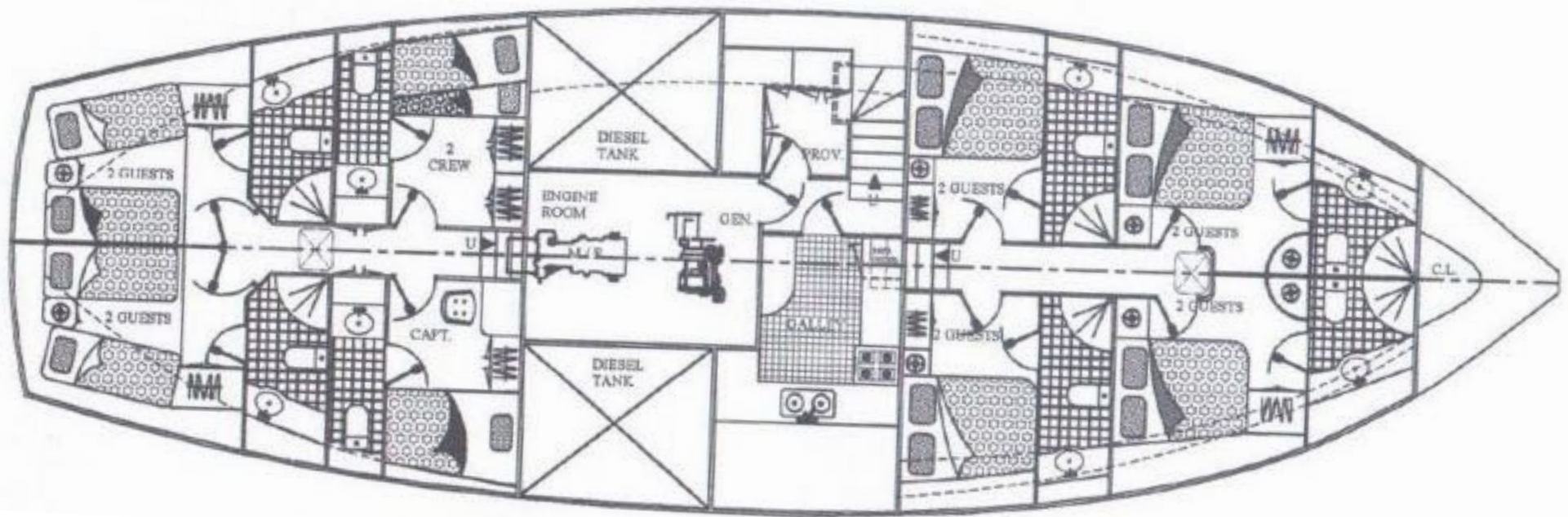

Specifications

Length: 29.87 m (98')

Beam: 2.95m (9' 67")

Draft: 2.74 m (9' 1")

Year built: 2003/2010/2013/2020-21

Builder: Ege Yacht

Accommodation:

12 guests in 6 cabins all with private facilities:

Four double guest cabins are forward of the salon, while two twin guests cabins are aft of the salon. All with private bathrooms

Crew: 4

Engines & Generators:

Aifo Iveco 350 hp |

2 x Northern Lights 10 & 22 Kw

Fuel consumption: 55 lts/hr

Cruising speed: 8,5 knots

Audio Visual Equipment and Deck Facilities:

Tender 5,20 with 60 HP

2 X seawing

3 X SUP

1 X inflatable kayak

1 X platform 2m x 3m

2 pair of water ski

1 X wakeboard

Snorkelling gear

OTHER AMENITIES:

hairdryers (6)

Washing machine/dryer (light laundry)

Iron (1)

Bathrobes for each guest

Pillows on each bed (4)

Bathroom Amenities (Shampoo, Conditioner, Shower gel,

Body Lotion)

The sailing schooner Myra was designed and built by the Turkish Ege Yat yacht builders in 2003, gradually refitted in 2010, 2013 and 2016. She is currently receiving a total refit and will be in like-new condition in late spring.

Extremely elegant, classic and refined, the sailing yacht Myra has a traditional vibe about her. Her exterior steel hull is an added value and a unique feature for a schooner. Her beautiful exterior feature a black-painted hull, gloss varnished bulwarks and teak deck. The interior is spacious and warm boasting fine woods panels and teak-holly inlay floors. The salon is in the raised deck house, large ports allow ample natural light and great viewing. On the port side 2 formal dining tables seat all 12 guests with room to spare, on the starboard side a built in lounge and coffee table invite guests to relax in comfort. A flat screen TV and audio system is available for indoor entertainment. Four double guest cabins are forward of the salon, while 2 twin guests cabins are aft of the salon. Exterior living on charter yacht MYRA is plentiful. The aft deck offers an alfresco dining option, seating and aft facing sunbeds, shade from a Bimini cover can be provided. Additional sunbeds on the foredeck allow everyone to find a place to relax.

The sailing schooner Myra boasts generous wrap around teak decks, with high rails, the yacht is easy to walk around both at anchor and under sail. Myra is RINA and CE certified.

